



ROOM PRESENTATION

GROSSES THEATER

LIGHTHOUSE

Industrial charm meets modernity



The highlight of the WHITE Spree lounge is the lighthouse with a 180° view of the Spree. In a beautiful ambience and with a unique view, your guests will feel completely at ease. The cozy outdoor terrace completes the 500m² location. The Lighthouse is divided into the panorama lounge, the large and the small theater, which leave nothing to be desired.

Whether it's a simple conference, evening event or product presentation - we make your ideas possible. The Lighthouse is also perfect for dreamy weddings. The location is barrier-free and can also be accessed by car for presentation purposes.

INCLUDED

- ✓ Banquet and meeting seating
- ✓ Standing tables with covers
- ✓ Projectors & screens
- ✓ Ethernet & WiFi connection
- ✓ Exclusive Spree terrace
- ✓ High-quality outdoor lounge furniture
- ✓ Modern lighting and sound technology
- ✓ Heavy current indoor & outdoor

CAPACITIES



180

50

40

10

110

110

IMPRESSIONS INDOOR



IMPRESSIONS OUTDOORS



SEATING GALA

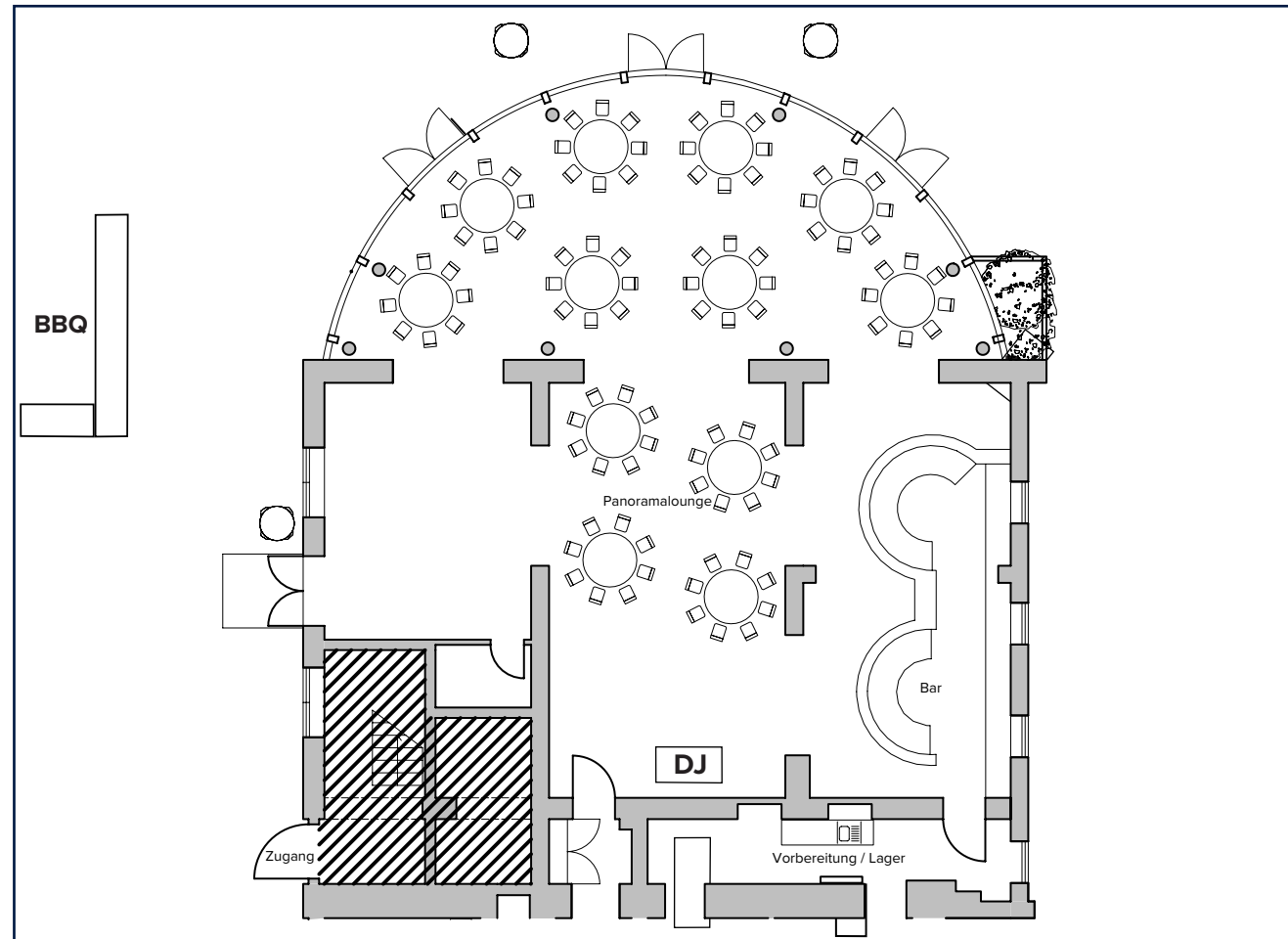

THIS IS WHAT YOUR EVENT WITH 96 PEOPLE COULD LOOK LIKE

BANQUET SEATING

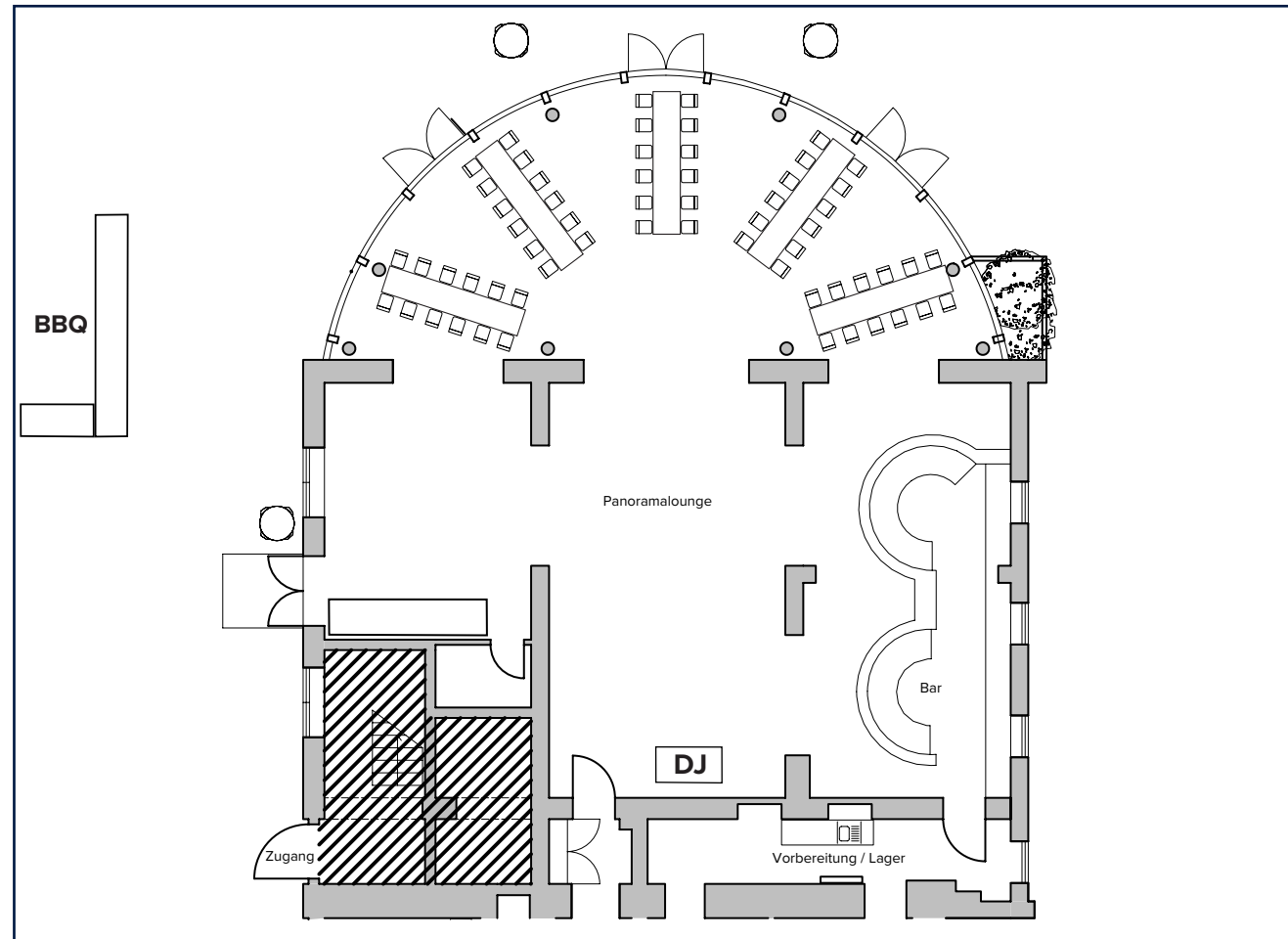

THIS IS WHAT YOUR EVENT WITH 60 PEOPLE COULD LOOK LIKE

SEATING STANDING TABLE BRIDGES

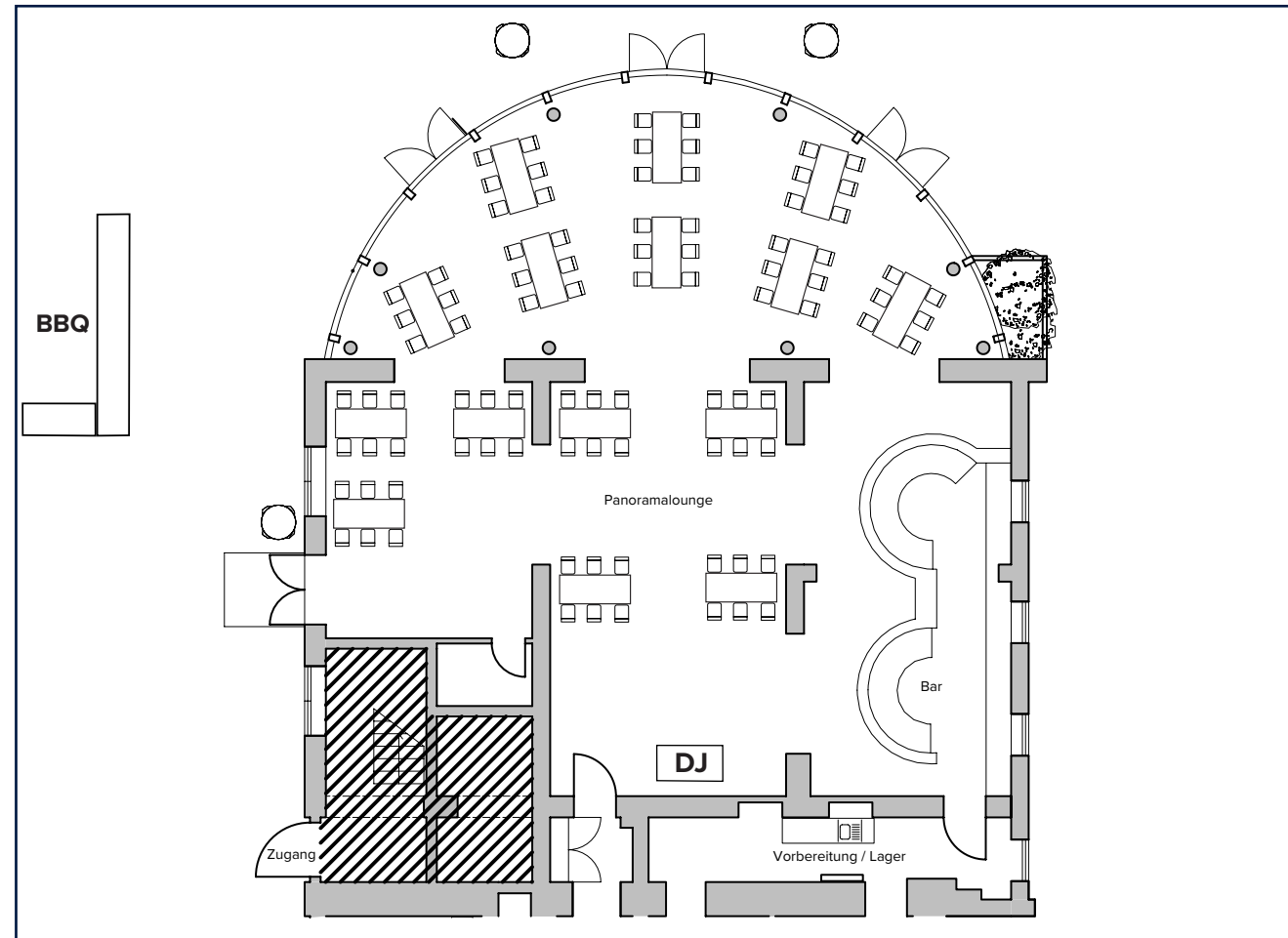

THIS IS WHAT YOUR EVENT WITH 90 PEOPLE COULD LOOK LIKE

This architectural floor plan depicts a building complex with a mix of indoor and outdoor spaces. The plan includes the following labeled areas and features:

- Outdoorbereich** (Outdoor area): 638.61 m, located at the top left.
- Holzpodest** (Wooden platform): Located near the top left outdoor area.
- SPREE**: Indicated by wavy lines at the top of the plan, representing a body of water.
- Panoramalounge** (Panoramic lounge): 61.50 m, a curved room at the top right.
- Fläche** (Area): Three rectangular areas are specified: 30.45 m, 36.26 m, and 24.39 m.
- WC Damen** (Women's toilet): Located in the central part of the plan.
- WC Herren** (Men's toilet): Located below the women's toilet.
- Behinderten WC** (Disabled toilet): Located between the women's and men's toilets.
- Küche** (Kitchen): Located in the bottom right section.
- Vorbereitung / Lager** (Preparation / Storage): Located above the kitchen.
- Zugang** (Entrance): Multiple entrances are marked throughout the plan.
- Rampe Einfahrt PKW** (Ramp car entrance): Located on the left side.
- Podest** (Platform): Located near the ramp.
- Glas-Scheibewand** (Glass partition wall): Located near the ramp.
- Flur** (Corridor): A central horizontal corridor.
- 7.00m**: A vertical dimension line on the left side.
- 5.43 m**: A horizontal dimension line at the top.
- 13.74 m**, **6.97 m**, **11.05 m**, **20.96 m**, **5.87 m**, **4.87 m**, **5.40 m**, **6.73 m**: Various other dimensions and measurements throughout the plan.



NOW LET'S GET INTO THE DETAILS

Do you already know the digital event planner?

The digital event planner gives you a detailed overview of the planning status of your event. At any time you can see which details of your event still need to be planned, you can select dishes, adjust seating plans and look at the relevant decoration, entertainment and technology catalogues.

All changes can be viewed and adjusted by you and your contact person in the White Spreelounge. You will receive the access data from your personal contact person, who will be happy to answer any questions you may have.

Just make sure you stop by!

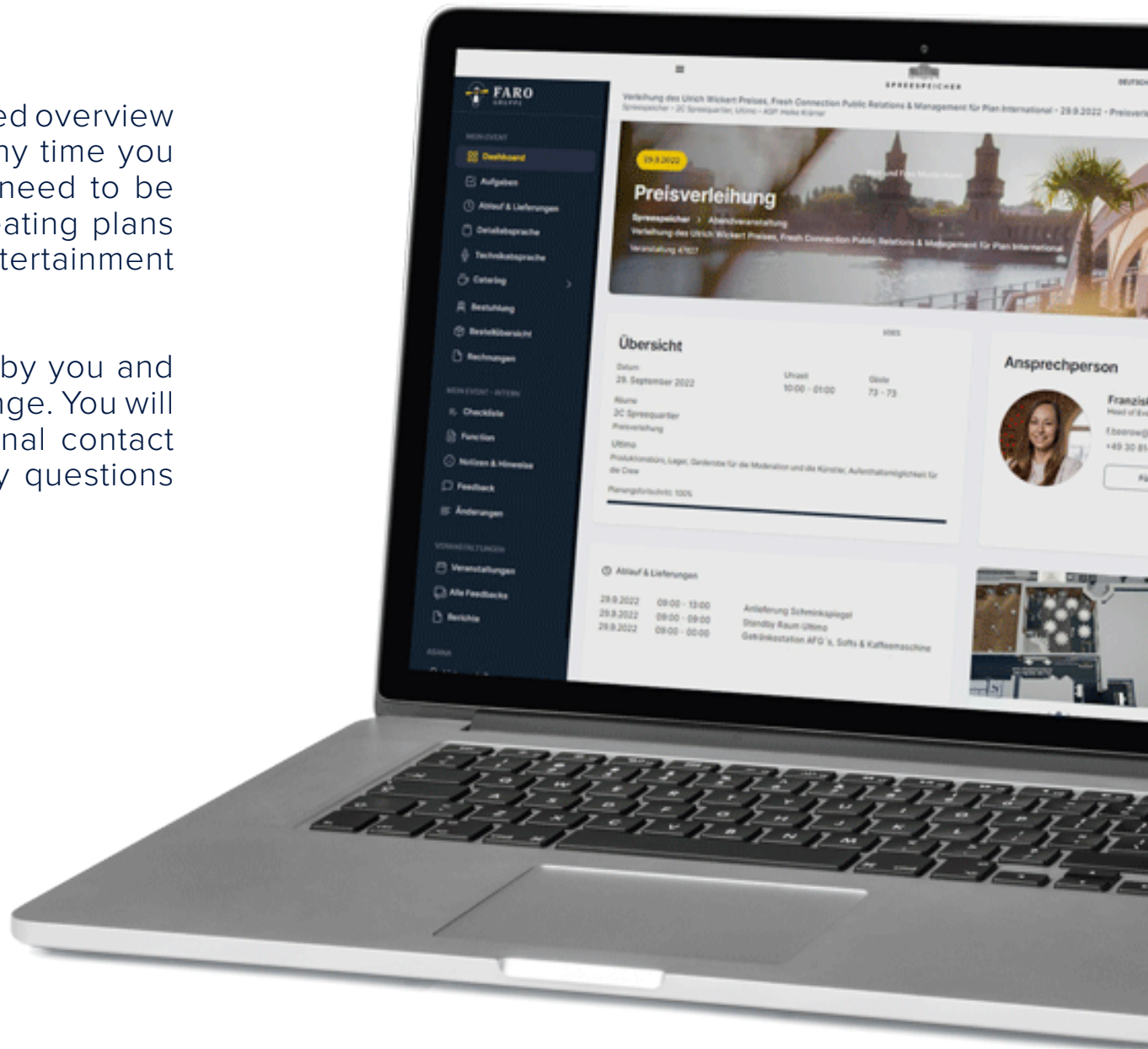

CONTACT

We will be happy to advise you on your individual ideas and adapt your offer to the desired equipment. Please get in touch with your personal contact person at any time.

Arrival by car

You can come along in the parking lot at Penny Markt Parking disc for up to three hours. From there go past the cinema on the right. Behind the driveway is the entrance to the location. Don't forget your parking disc!

Public transportation

Less than 40 meters away, you will find the tram station Wilhelminenhofstr./Edisonstraße, from which you can go directly to the S Bahn station, 700m away Drive to Schöneweide and all the others from there accessible by public transport in the area.

WHITE SPREELOUNGE GMBH

Tel. +49 30 4036563-00

kontakt@white-spreelounge.de

www.white-spreelounge.de

